



## Flat 4, 10 Queens Road

Farnborough, GU14 6DN

£1,650 PCM

Step into luxury living with this beautifully presented, fully furnished penthouse apartment, ideally located in the heart of North Camp Village. Boasting two generously sized double bedrooms, the master complete with a private en-suite, this stylish home offers comfort, space, and modern convenience. Ample storage throughout and an allocated parking space add to the practicality, making this a truly exceptional rental opportunity. \*DRAUGHT FLOORPLAN\*

This high end apartment is ideally situated in the popular village of North Camp and just a short distance to three railway stations – North Camp Station (0.9 miles), Ash Vale Station (1.5 miles) and Farnborough Main Station (1.6 miles). It is also within walking distance to the local village shops and has easy access to the A331 and M3.

Available mid August.

### Viewing

Please contact our Fosters Lettings Office on 01252 344333 if you wish to arrange a viewing appointment for this property or require further information.

- Superb Apartment
- Modern Throughout
- Top floor Penthouse
- Available Now
- Fully furnished
- Parking
- Northcamp Village
- 5 Week Deposit £1903.84
- Council Tax Band B
- EPC Energy Rating Band (B) 84



2



2



1



B



Floor Plan

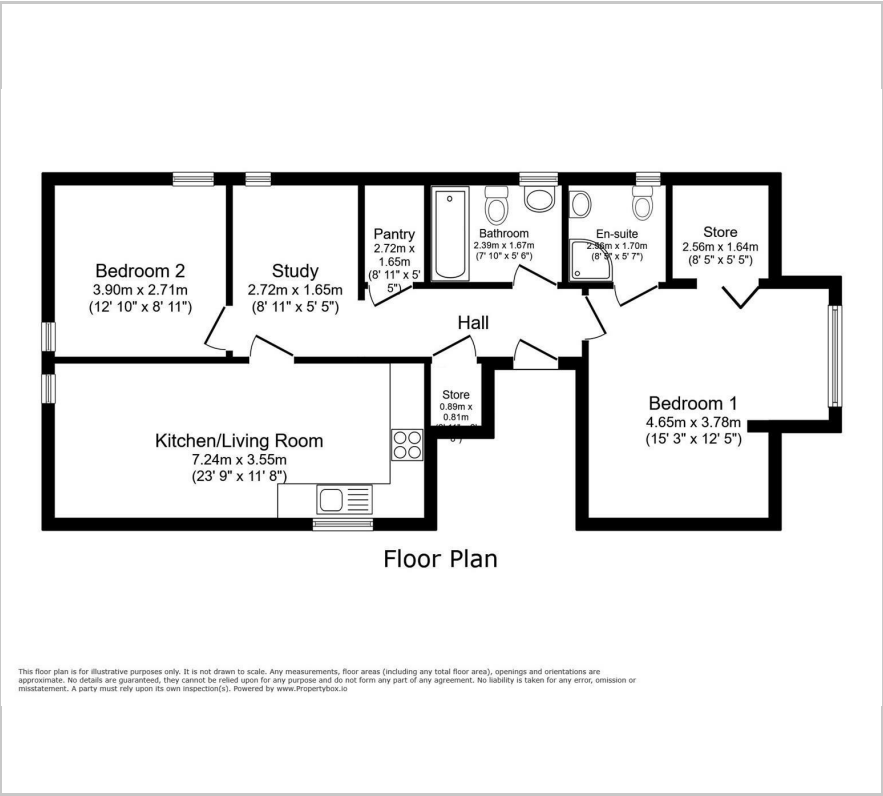

Area Map



Energy Efficiency Graph

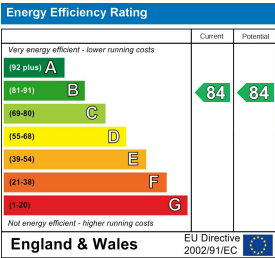

These particulars, whilst believed to be accurate are set out as a general outline only for guidance and do not constitute any part of an offer or contract. Intending purchasers should not rely on them as statements of representation of fact, but must satisfy themselves by inspection or otherwise as to their accuracy. No person in this firms employment has the authority to make or give any representation or warranty in respect of the property.